

ITEM	DESCRIPTION	MATERIAL	QTY
1	GASKET	EPDM RUBBER	1
2	COUPLING HOUSING	DUPLEX 2205 CE8MN / SUPER DUPLEX CE8MN / CE3MN	3
3	HEAVY HEX NUT	DUPLEX 2205 / 316 STAINLESS STEEL	3
4	HEX HEAD, SQUARE NECK TRACK BOLT	DUPLEX 2205 / 316STAINLESS STEEL	3
5	WASHER	DUPLEX 2205 / 316STAINLESS STEEL	6

PRESSURE RATING:

NOMINAL SIZES	RATED PRESSURE	PROOF TEST PRESSURE
16" - 18"	1200 PSI (83 BAR)	1800 PSI (125 BAR)

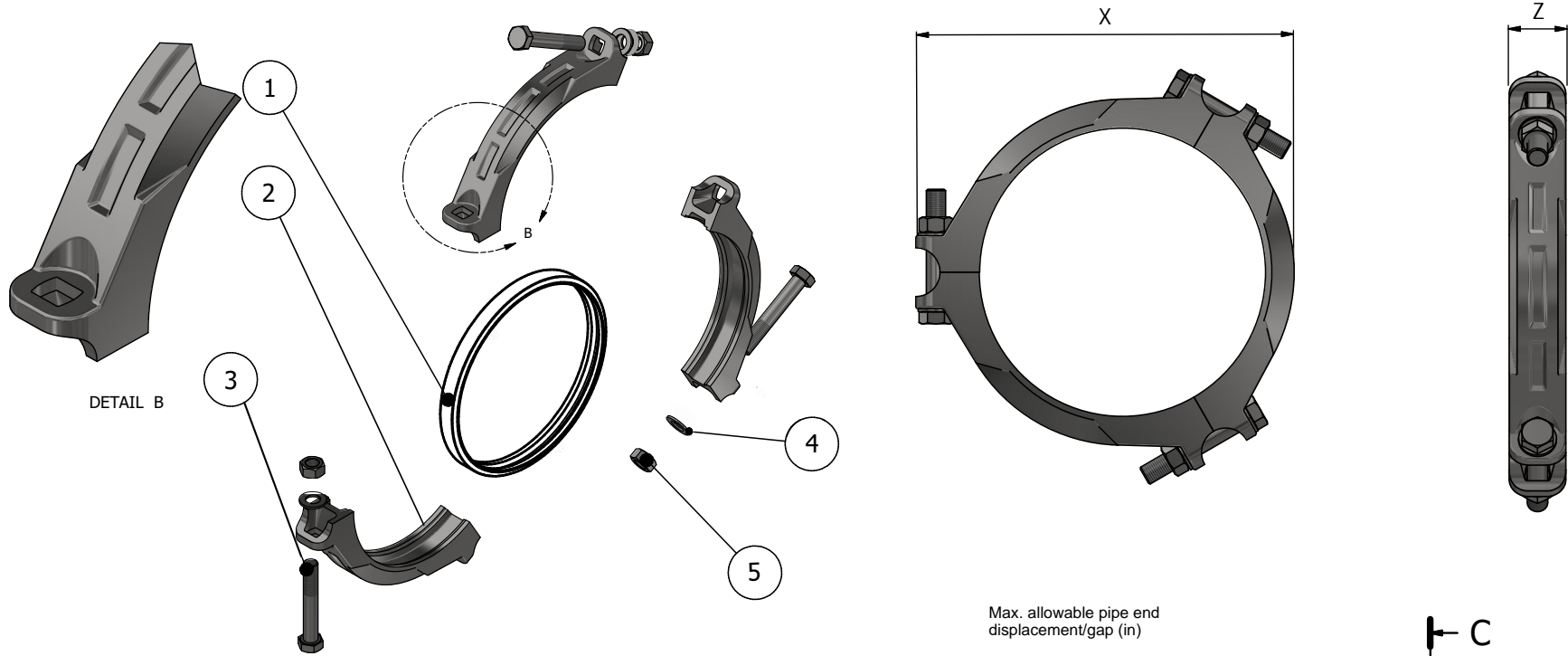

Max. allowable pipe end displacement/gap (in)



SECTION C-C

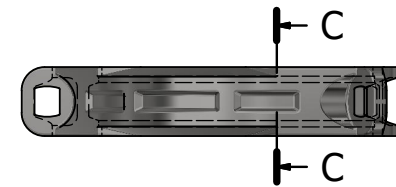

- DIMENSIONS SHOWN IN THE DRAWING ARE INDICATIVE. FOR DETAILED INFORMATION ON GD&T, CONTACT PIEDMONT.
- COUPLING IS PRESSURE RATED FOR SCH. 40 PIPE (OR THICKER) WITH CUT GROOVES ONLY ACC. TO AWWA C606.
- HOUSING MATERIAL IS DUPLEX (CE8MN) OR SUPER DUPLEX (CE8MN/CE3MN) STEEL CONFORM TO ASTM A995/A995M-13.
- BOLTS ARE HEX HEAD, SQUARE NECK TRACK BOLT, 2205 DUPLEX OR SS316.
- NUTS ARE HEAVY HEX 2205 DUPLEX OR SS316 CONFORM TO DIN-934.
- GASKETS ARE EPDM RUBBER (FLUSH-FIT/C-SHAPE)
- WASHER ARE 2205 DUPLEX OR SS316 CONFORM TO DIN-125.
- SINCE D 16 & D18 ARE A 3-PIECES COUPLING, THE MINOR SIZE D STYLE COUPLINGS TYPICAL DIMENSIONS R1, R2 AND RK ARE NOT RELEVANT HERE.
- DUPLEX HARDWARE IS RECOMMENDED FOR HIGH PRESSURE SWRO CORROSIVE APPLICATIONS.

DIMENSIONS:

NOMINAL SIZE	PIPE OD	dk	X	Z	BOLTS QTY	BOLTS SIZE	APPROX. WT	MAX ALLOWABLE PIPE END DISPLACEMENT / GAP
MM [INCH]	MM [INCH]	MM [INCH]	MM [INCH]	MM [INCH]			KG [LB]	INCH
DN400 [16"]	406.4 [16.00]	55.118 [2.17]	542.54 [21.36]	74.68 [2.94]	3	M27 * 170	28.97 [63.87]	0.294"
DN450 [18"]	457.2 [18.00]	58.268 [2.294]	610.36 [24.02]	78.94 [3.11]	3	M27 * 170	38.890 [85.73]	0.294"

PROPRIETARY AND CONFIDENTIAL NOTE:

THE INFORMATION CONTAINED IN THIS DRAWING IS THE SOLE PROPERTY OF PIEDMONT PACIFIC ANY REPRODUCTION IN PART OR AS A WHOLE WITHOUT THE WRITTEN PERMISSION OF PIEDMONT PACIFIC IS PROHIBITED.

REV		DATE	REVISION DESCRIPTION	DRAWN	CHKD	ENG	APPVD
1.0		5/26/2020	GENERAL COUPLING ASSEMBLY OF STYLE D	IU	DJ	DJ	

Piedmont

UNLESS NOTED OTHERWISE
UNLESS NOTED OTHERWISE: ALL DIMENSIONS ARE IN INCHES AND DECIMALS THEREOF. SURFACE FINISH ON PARTS: 125 MICRO INCHES RA UNLESS OTHERWISE SPECIFIED. DO NOT SCALE PRINTS.

PIEDMONT PACIFIC
GROOVE END FLEXIBLE PIPE COUPLING

TITLE:

STYLE D16 & D18 COUPLING ASSEMBLY

SCALE:	UNIT:	DRAWING NO.	SHEET:	REVISION:
N/A	[INCH] / MM	1.0	1.0	1